



# Mechanical Diaphragm Type Metering Pump

## JWM-A, JWM-AD series

### Features

- ◆ Mechanical actuated diaphragm, no-leakage structure
- ◆ PVC, PTFE, PVDF, 304, 316 is available as the liquid end
- ◆ It is good for corrosion resistant medicine
- ◆ Can be mounted on chemical tank
- ◆ Easy installation and maintenance
- ◆ Enclosed power end for safety
- ◆ Capacity adjusted during operation, the range is 0~100%
- ◆ Auto-matic control who can accept 4~20mA is available (JWM-AD series)



Model	Capacity (LPH)		Max. Pressure (Bar)	Stroke (mm)	Speed (min-1)	Dia. Diaphragm	Connection	Motor power (KW)	Weight (KGS)
	50Hz	60Hz							
JWM-A 6.5/1	6.5	7.8	10	2	54	65	Connection: Tubing ID9 OD15 or 1" threaded, male BSPT/NPT	40	8.5
JWM-A 12/1	12	14.4		2	108				
JWM-A 24/1	24	28.8		4	90				
JWM-A 32/1	32	38.4		4	135				
JWM-A 42/1	42	50.4		5	135				
JWM-A 60/1	60	72		5	150				
JWM-A 80/0.5	80	96	5	4	150	84		60	
JWM-A 90/0.5	90	108		5	135				
JWM-A 100/0.5	100	120		5	150				
JWM-A 110/0.3	110	132	3	4	150	94			
JWM-A 120/0.3	120	144		5	135				
JWM-A 150/0.3	150	180		5	150				

Capacity (LPH)	PVC/PVDF					
	A/B	C	D	E	F	G
6.5~60	107	29	172	147	40	242
80~120	128	51	190	168	51	274
150	133	52	193	206	56	317.5

Capacity (LPH)	SS304/SS316					
	A/B	C	D	E	F	G
6.5~60	91	32	168	147	40	242
80~120	124	51	190	168	51	274
150	133	52	191	206	56	317.5

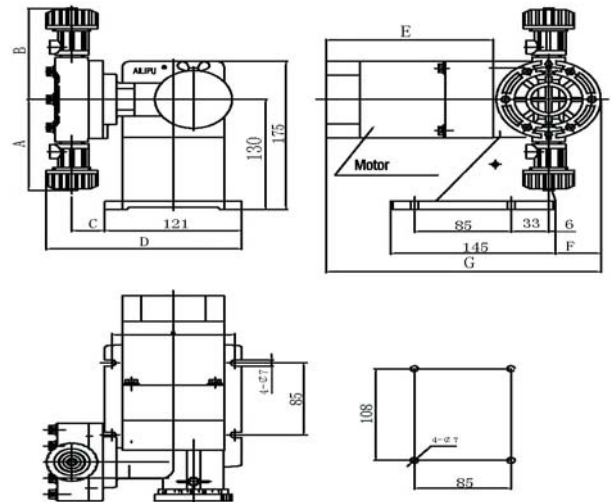

### Material

Pump head	Diaphragm	Ball valve	Valve seat/O-ring	Chemicals
PVC	PTFE/ EPDM	Ceramic	PTFE/FPM	Sodium hypochlorite, Aluminium sulfate, Ferric chloride, PAC, Sulfuric acid, Phosphoric acid, Urea, Anti foams, Calcium chloride, Aluminium chloride
		304/316	EPDM	Coagulant, Ammonia water, Hydrazin, Caustic soda